

Compact Flange (Center Spigot-joint) Double type CFTBCW series

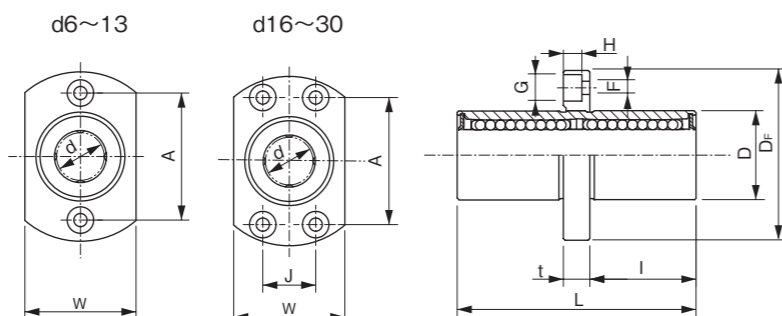

Shaft Diameter (mm)	Code Name	Major Dimensions (mm)												Perpendicularity (μm)	Eccentricity (MAX) (μm)	Basic Load Rating	
		d	D	L	D _F	t	J	W	A	F	G	H	I			C (N)	C ₀ (N)
6	CFTBCW-6UU	6	12	35	28	5	-	18	20	3.5	6	3.1	15	15	15	323	529
8	CFTBCW-8UU	8	15	45	32	5	-	21	24	3.5	6	3.1	20			431	784
10	CFTBCW-10UU	10	19	55	40	6	-	25	29	4.5	7.5	4.1	24.5			588	1,097
12	CFTBCW-12UU	12	21	57	42	6	-	27	32	4.5	7.5	4.1	25.5			656	1,195
13	CFTBCW-13UU	13	23	61	43	6	-	29	33	4.5	7.5	4.1	27.5			813	1,568
16	CFTBCW-16UU	16	28	70	48	6	22	34	31	4.5	7.5	4.1	32	1,225	2,352		
20	CFTBCW-20UU	20	32	80	54	8	24	38	36	5.5	9	5.1	36	20	20	1,401	2,744
25	CFTBCW-25UU	25	40	112	62	8	32	46	40	5.5	9	5.1	52			1,558	3,136
30	CFTBCW-30UU	30	45	123	74	10	35	51	49	6.6	11	6.1	56.5			2,489	5,488

● Code Name

